



Regal Style

46" Square Regal Table with (3) Attached Seats, Rounded Corners - ADA Surface Mount.

- 46" x 57" ADA Top.
- 305 Lbs.
- Top and seats are made with heavy duty pvc or polyethylene 3/4" #9 expanded metal inside a 2" x 2" x 1/8" angle iron frame.
- Zinc coated, galvanized, powder coated, single 4" pedestal.
- With or without umbrella hole.
- Some assembly required.
- Insert shows actual frame style.

Item #: WC RSQ46ADA3SM

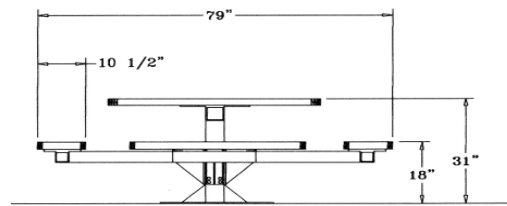

Regal Style

46" Square Regal Table with (3) Attached Seats, Rounded Corners - ADA Inground Mount.

- 46" x 57" ADA Top.
- 305 Lbs.
- Top and seats are made with heavy duty pvc or polyethylene 3/4" #9 expanded metal inside a 2" x 2" x 1/8" angle iron frame.
- Zinc coated, galvanized, powder coated, single 4" pedestal.
- With or without umbrella hole.
- Some assembly required.
- Insert shows actual frame style.

Item #: WC RSQ46ADA3IG

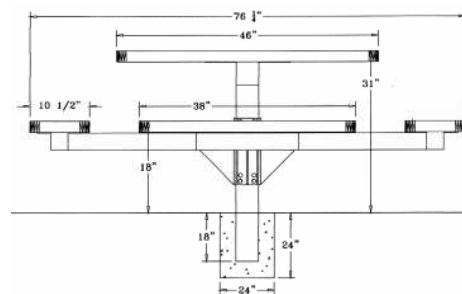

Colors



*Blue *Mystic Blue**Mariner Blue *Teal



*Purple **Red *Burgundy **Yellow



**Green **Black **Brown *Clay



*Gray *White *Orange *Sandstone

* Available in Polyethylene only
 ** Available in Polyethylene and Plastisol

Plastisol Finish



Polyethylene Finish



NATIONAL OUTDOOR FURNITURE, INC.

P.O. Box 296 Riverhead, NY 11901
 Toll-Free Phone: 1-888-663-4621
 Phone: 631-369-9099 Fax: 631-207-8312
 Email: nofinc@optonline.net
www.outdoorchaise.com

NATIONAL OUTDOOR FURNITURE, INC.

P.O. Box 325 Pomfret Center, Ct 06259
 Toll-Free Phone: 1-888-516-8873
 Phone: 1-860-974-9996 Fax: 516-706-1901
 Email: nofinc@earthlink.net
www.outdoorchaise.com